

# NEXO



# Because of You.

We created NEXO, the first dedicated fuel cell electric vehicle, because we're committed to a connected, free, and clean tomorrow. One in which vehicles co-exist with us and our environment, liberate us from constraints and make a big impression – without making a sound, or leaving a mark.

It's all driven by a simple philosophy. That from this moment everything we do is because of you. Nexo won't change life for the next generation of motorists – it'll change life as we know it.



# Because of Femita.

We all have a vision for a better tomorrow. Ours is to make the world a better place because of you, and people like Femita.

NEXO produces zero emissions, purifying the air instead of polluting it. This leaves Femita free to focus on chasing her better tomorrow with technology that allows her to live without limits, while making a positive impact on her life, and the lives of others.



Femita Ayanbeku : U.S Paralympic Athlete



# Hydrogen, the future of fuel.

We believe that hydrogen energy is the key to building a more sustainable future for Femita, and for us all.

NEXO's hydrogen fuel cell engine generates electricity by mixing oxygen with compressed hydrogen to create a flow of electrons. It's intelligent, efficient, and only emits pure, clean water.





# Because of Liam.

Air is purified so he can breathe freely in a healthy environment today, and well into the future.





## Air purification, for a brighter future.

The efficient and durable high-performance air purifier filters and removes 99.9% of micro-particulates. This means NEXO's clean technology helps reduce carbon emissions, even while driving.



# Because of Spike.

Spike lives his life on the go.  
He hates waiting while his owner recharges at the station.

NEXO will liberate Spike from the constraints of slow electric charging and let him get back to doing what he enjoys most – living his best life.





# Fast refueling, remarkable range.

Hydrogen fuel cells take just five minutes to fill, and can drive more than 600Km before needing to be filled up again. That's similar to most petrol cars, and certainly enough range for even the most impatient four legged friends.



\*Aforementioned figures and charging equipment may vary by market.



# Because of Anna.

NEXO constantly finds ways to liberate people from their restraints. Like Anna, who often finds herself in a tight spot.

Remote parking means even the most narrow parking space is no longer a problem. She can get out, press a button, and watch the NEXO park itself snugly.

It's a big help to other drivers too. Sensors guide the NEXO into the park first time, meaningless waiting and no more dents or scratches.



\*Remote parking (parallel and perpendicular parking) needs to be operated with full attention until parking is done under safe circumstances.



Horizon LED positioning lamps

# An exterior inspired by tomorrow.

NEXO is a bold step towards a better future. We've styled the exterior to reflect this, making it as streamlined and sublimely futuristic as possible.

Cascading grille and horizon LED positioning lamps propel it forward, thoughtful detailing - including streamlined auto flushed door handles that sink back into the car - give it a seamless look that complements the innovative design.



D-pillar air tunnel



Auto flush door handles

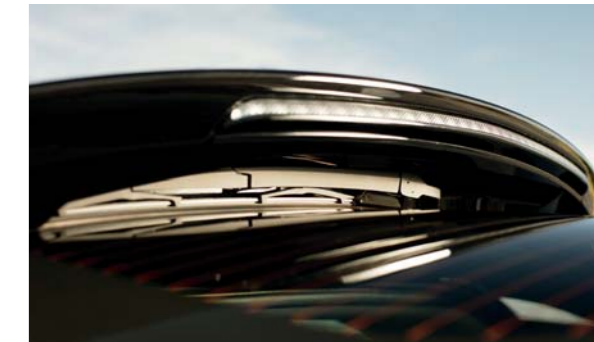

Hidden rear wiper



Blind-spot view monitor



Wireless charging



Spacious trunk (SAE 839L, VDA 461L)

# An interior inspired by you.

NEXO's stylish and highly functional interior has been crafted to ensure everything is at your fingertips and within your line of sight. This includes a bridge type centre console that allows you to comfortably, and safely adjust any setting to your liking, without having to take your eyes off the road.

It's spacious too, with more boot space than any other fuel cell vehicle on the market today.

And as you'd expect from such an environmentally compatible vehicle, everything is made from eco-friendly materials - designed to keep you moving forward, while limiting your footprint.



7" cluster + 12.3" navigation

# Because of Carla.

We understand that everyone moves to a different beat - like Carla who gets a real kick out of her daily commute.

That's why we've fitted NEXO with intelligent safety features, designed to keep you aware of everything going on around you - and alert you to the hazards you haven't yet seen.

It's all part of our commitment to safer streets, so drivers like you, and pedestrians like Carla, can confidently go their own way.

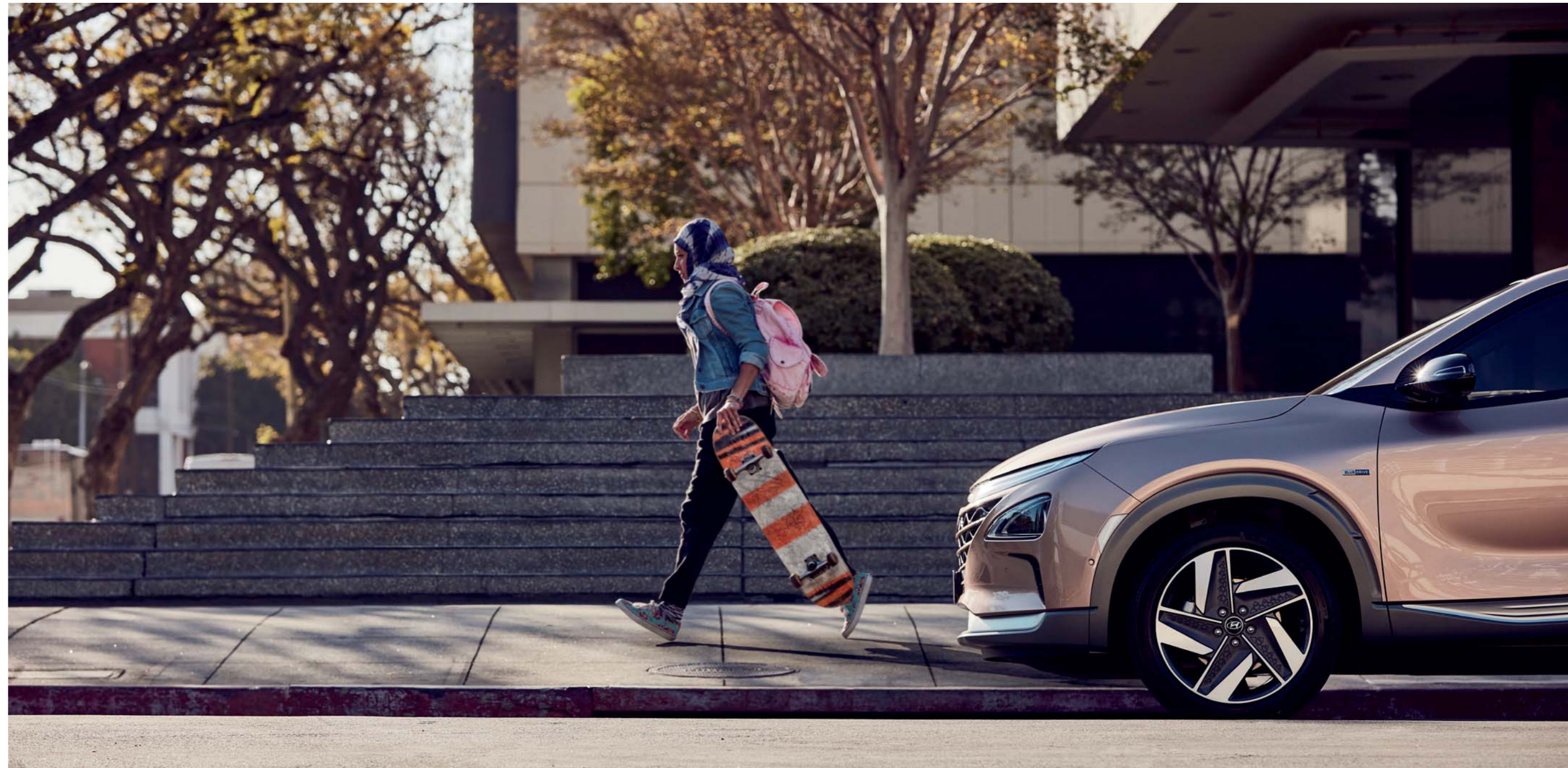

# Hyundai SmartSense

NEXO has been fitted with cutting edge safety technologies, because when it comes to safety we're thinking far beyond today.



## Forward Collision-Avoidance Assist (FCA)

Front view camera and front radar are in place to warn the driver of imminent collisions with other vehicles, or even certain types of objects; and if necessary apply emergency braking to prevent from collision.

\* Forward Collision Warning (FCW) is included in this feature. / \* FCA - Camera Type only detects vehicles.

## Smart Cruise Control with Stop & Go (SCC w/ S&G)

This system will maintain the driver's pre-set speed and distance from the vehicle ahead without requiring the driver to use the accelerator or brake pedals.



## Lane Keeping Assist (LKA) / Lane Following Assist (LFA)

A front view camera detects lane markers and road edges helping prevent unintentional lane departures. When the vehicle strays from its lane (or road), the system sets off a visual and sound alarm and automatically steer the vehicle to prevent it from moving out of its lane (or road).

\* Lane Departure Warning (LDW) function is included in this feature.



## Rear Cross-Traffic Collision-Avoidance Assist (RCCA)

Radar sensors in the rear bumper monitor cross traffic approaching from left and right side of the vehicle during reverse maneuvers, and if necessary apply emergency braking to prevent from collision.

\* Rear Cross-Traffic Collision-Avoidance Warning (RCCW) is included in this feature.



## Blind-Spot Collision-Avoidance Assist (BCA)

Radar sensors in the rear bumper are used to warn the driver of approaching vehicles in the blind spot area and activate the brakes when there is a collision risk in lane changing maneuvers.

\* Blind-Spot Collision Warning (BCW) is included in this feature.



# Features



17" alloy wheel

19" alloy wheel



Cascading grille / Horizon LED positioning lamp



Split-type composite light



LED rear combination lamp



Surround view monitor



Shift-by-wire transmission



Paddle shift (regenerative braking control)



Wide sunroof



Power tailgate



Air curtain



Smart key



KRELL premium sound



Front ventilated / heated seat



# Exterior colors



Creamy White Pearl (TW3)

Copper metallic (R3C)

Titanium Gray Matte (Y3G)

Ocean Indigo Pearl (PS8)

Amazon Gray metallic (A5G)

# Interior colors

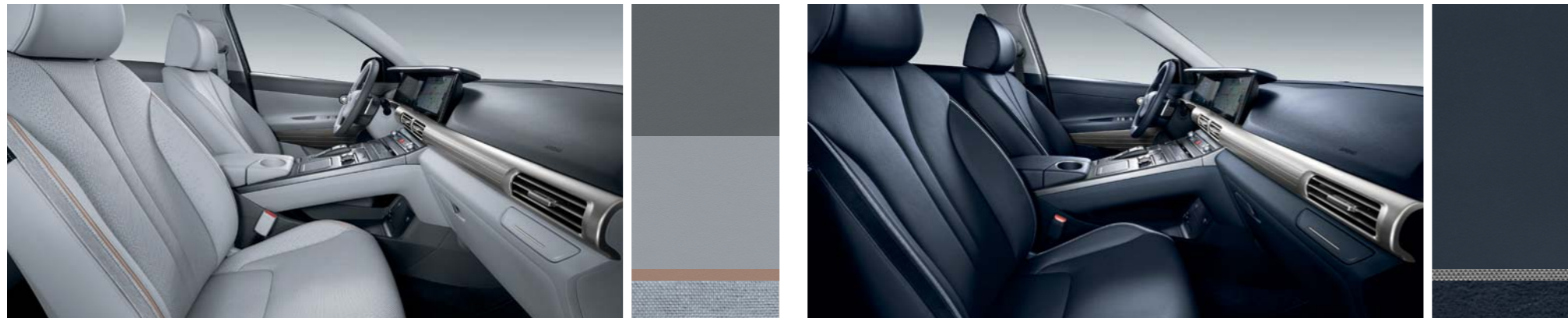

Gray two-tone interior

Blue one-tone interior

# Specifications

Type		
Motor	Permanent-magnet synchronous motor (PMSM)	
Max. Power (kW)	120	
Max. Torque (Nm)	395	
Battery		
Capacity (kWh)	1.56	
Power output (kW)	40	
Suspension		
Front	McPherson strut type	
Rear	Multi-Link Type	
Tire	225/60R17, 245/45R19	
Dimensions		
Head room (mm)	Front (w / Sunroof) / Rear	1,001 (966) / 965
Leg room (mm)	Front / Rear	1,054 / 981
Shoulder room (mm)	Front / Rear	1,454 / 1,409

- The above values are results from internal testing and are subject to change after validation.
- Some of the equipment illustrated or described in this catalog may not be supplied as standard equipment and may be available at extra cost.
- Hyundai Motor Company reserves the right to change specifications and equipment without prior notice.
- The color plates shown may vary slightly from the actual colors due to the limitations of the printing process.
- Please consult your dealer for full information and availability on colors and trims.



Wheel Tread\* 1,614  
Overall Width 1,860



Wheel Base 2,790  
Overall Length 4,670

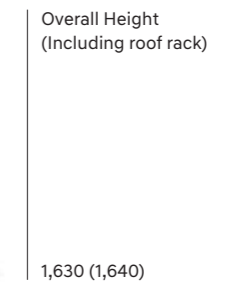

Overall Height (Including roof rack) 1,630 (1,640)



Wheel Tread\* 1,625  
Overall Width 1,860

Unit : mm \* Wheel Tread • 17" (Front/Rear) : 1,618 / 1,629

For our better  
tomorrow.



Dealer stamp